



## 22 Trevoze Way

Efford, Plymouth, PL3 6PF

**£925 Per Calendar Month**



VIEWING DAY FULL Available from June is this lovely modern mid-terraced property. It is located in a good cul-de-sac location & the accommodation briefly comprises a modern fitted kitchen, lounge/dining room, conservatory, 2 bedrooms & modern bathroom. Rear garden & allocated residents' parking to the front. Double-glazing & gas central heating.



## TREVOSE WAY, EFFORD, PL3 6PF

### ACCOMMODATION

Access to the property is gained via the uPVC part double-glazed entrance door leading into the entrance porch.

### ENTRANCE PORCH

Built-in cloak cupboard. Inner door leading into the lounge/dining room.

### LOUNGE/DINING ROOM 16'0" x 9'10" (4.88 x 3.01)

Stairs rising to the first floor accommodation. Under-stairs storage cupboard. 'Living Flame' gas fire. Double-glazed window to the rear elevation. Double doors leading into the conservatory. Doorway opening into the kitchen.

### KITCHEN 8'9" x 7'7" incl kitchen units (2.67 x 2.32 incl kitchen units)

Series of modern matching eye-level and base units with rolled-edge work surfaces and tiled splash-backs. Inset one-&-a-half bowl single drainer sink unit with mixer tap. 4-ring gas hob with an electric oven beneath. Space and plumbing for washing machine. Space for fridge-freezer. Double-glazed window to the front elevation.

### CONSERVATORY 10'7" x 7'7" (3.25 x 2.32)

Pitch polycarbonate roof. Wood-effect laminate floor. Power and light. Double-glazed windows to 3 elevations. Doorway leading out to the rear garden.

### FIRST FLOOR LANDING

Providing access to the first floor accommodation. Built-in cupboard with slatted shelving and housing the gas boiler. Loft hatch. Double-glazed window to the front elevation.

### BEDROOM ONE 8'2" x 12'1" to wardrobe rear (2.50 x 3.70 to wardrobe rear)

Built-in mirror-fronted wardrobe. Laminate floor. Double-glazed window to the rear elevation.

### BEDROOM TWO 7'10" x 7'5" (2.39 x 2.27)

Double-glazed window to the rear elevation.

### BATHROOM 6'5" x 5'6" plus door recess (1.97 x 1.68 plus door recess)

White suite comprising a panel bath with mixer tap, spray attachment, tiled area surround and shower screen, low level toilet and pedestal wash basin with mixer tap. Vertical towel rail/radiator. Laminate floor. Obscured double-glazed window to the front elevation.

### OUTSIDE

To the front there is a gravelled and planted front garden area together with an outside storage cupboard. At the rear of the property there is a fenced-enclosed garden which is mainly laid to lawn. There is a small planted area, rotary washing line and a storage unit.

### COUNCIL TAX

Plymouth City Council  
Council tax band B

### Rental holding deposit

The agent may require a holding deposit equivalent to a week's rent in order to secure the property. This amount would then be deducted from the 1st month's rent.

## Area Map



## Floor Plans

GROUND FLOOR

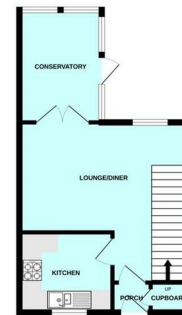

1ST FLOOR

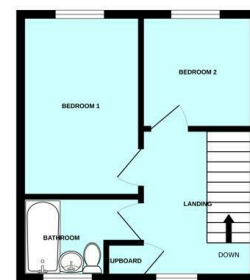

## Energy Efficiency Graph

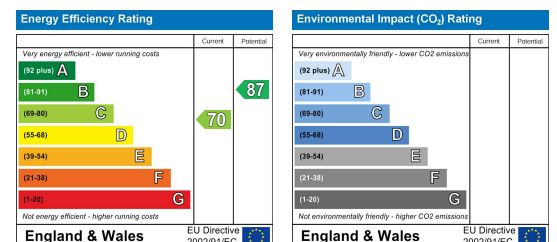

These particulars, whilst believed to be accurate are set out as a general outline only for guidance and do not constitute any part of an offer or contract. Intending purchasers should not rely on them as statements of representation of fact, but must satisfy themselves by inspection or otherwise as to their accuracy. No person in this firm's employment has the authority to make or give any representation or warranty in respect of the property.